



**RYAN KIPPES** 520.265.1895  
VICE PRESIDENT ryan.kippes@abimultifamily.com  
AZ Lic # SA660419000

**DESIREE PALMER** 520.265.1993  
VICE PRESIDENT desiree.palmer@abimultifamily.com  
AZ Lic # SA682872000

**NATHANIEL MCADOO** 520.265.1945  
ASSOCIATE nathaniel.mcadoo@abimultifamily.com  
AZ Lic # SA698399000

### TOTAL UNIT INVENTORY

100+ UNIT PROPERTIES: **72,083**

10+ UNIT PROPERTIES: **101,839**

### Q3 2023 Sales Stats



### Avg Sales Price Per Unit

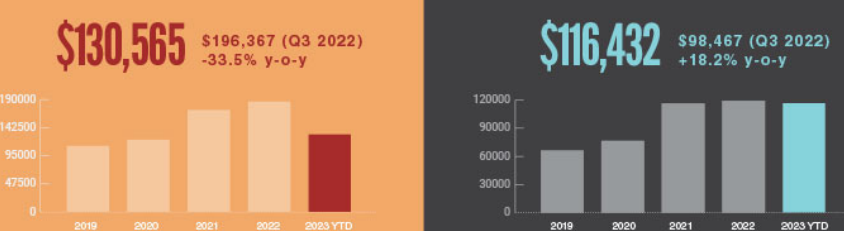

### 100+ UNIT PROPERTIES | Q3 2023 TRANSACTIONS BY YEAR BUILT

Year Built	Avg Price/Unit	Avg Price/SF	# of Transactions
2010+	--	--	--
2000-09	--	--	--
1990-99	--	--	--
1980-89	\$131K	\$228	2
Pre-1980	--	--	--

### 10-99 UNIT PROPERTIES | Q3 2023 TRANSACTIONS BY YEAR BUILT

Year Built	Avg Price/Unit	Avg Price/SF	# of Transactions
2010+	--	--	--
2000-09	\$119K	\$134	1
1990-99	--	--	--
1980-89	\$135K	\$227	3
Pre-1980	\$98K	\$182	6

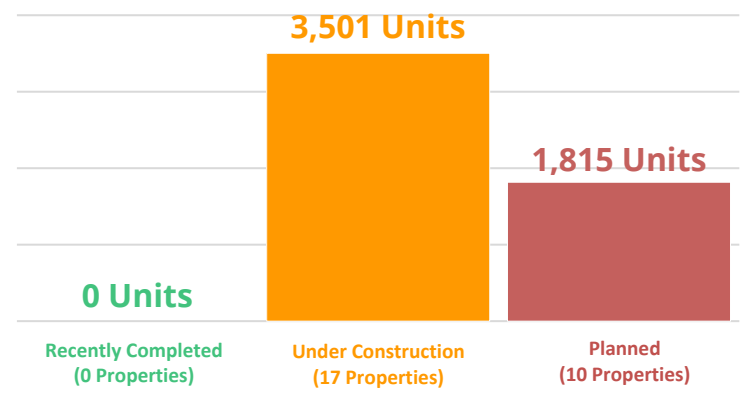
**TUCSON MSA CONSTRUCTION PIPELINE – Q3 2023**

**Recently Completed**

**Under Construction**

**Planned**

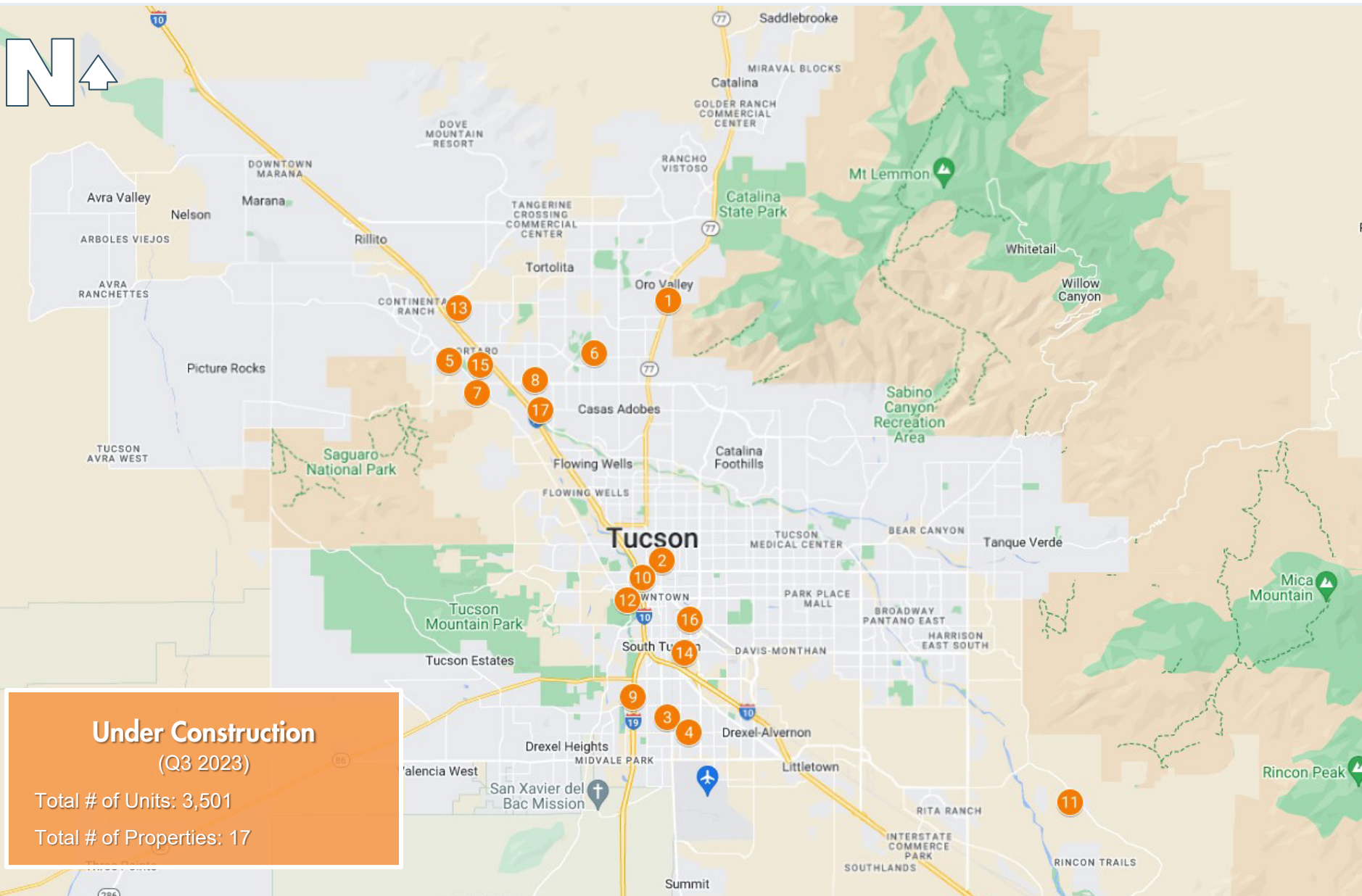

**Under Construction**  
 (Q3 2023)

Total # of Units: 3,501

Total # of Properties: 17

## UNDER CONSTRUCTION (50+ UNIT PROPERTIES)

	Property Name	Address	Units	Permit Date	Developer
1	Linda Vista	375 East Linda Vista Blvd	64	07/01/2022	Aerie Development
2	Cascade	1346 North Stone Ave	70	05/01/2023	COPE Community Services
3	Newport at the Rodeo	5301 South Nogales Hwy	77	11/14/2022	Newport Partners
4	Rio Mercado	5489 South Park Ave	107	11/30/2021	Moore, Gregory Eric
5	Album Marana	7760 North Silverbell Rd	141	01/01/2022	Greystar
6	Place at Arroyo Verde, The	8150 North La Cholla Blvd	156	04/09/2023	MC Companies
7	Amavida Marana	5555 West Ina Rd	200	06/13/2023	Ascent Companies
8	Alexander, The	3915 West Aerie Dr	209	09/01/2022	Sears Financial
9	Tucson Landing	4640 Calle Santa Cruz	210	01/02/2023	HCW Development
10	Presidio Palms	475 North Granada Ave	212	08/31/2023	Sterling Real Estate Partners
11	Moderne at Rocking K	7720 South Rocking K Ranch Loop	224	05/10/2023	Moderne Communities
12	Bautista, The	165 South Linda Ave	256	07/31/2023	Gadsden Company, The
13	Encantada Twin Peaks	6355 Marana Center Blvd	272	09/01/2022	HSL Properties
14	Cabana Bridges	1102 East 36th St	288	05/31/2022	Greenlight Communities
15	Place at Silverbell Gateway, The	7430 North Silverbell Rd	300	03/01/2022	MC Companies
16	ARI on Fourth, The	213 North 4th Ave	323	11/25/2022	Opus Group, The
17	Solstice Living	4105 West Aerie Dr	392	12/10/2022	M3 Multifamily
<b>Total Under Construction</b>			<b>3,501</b>		

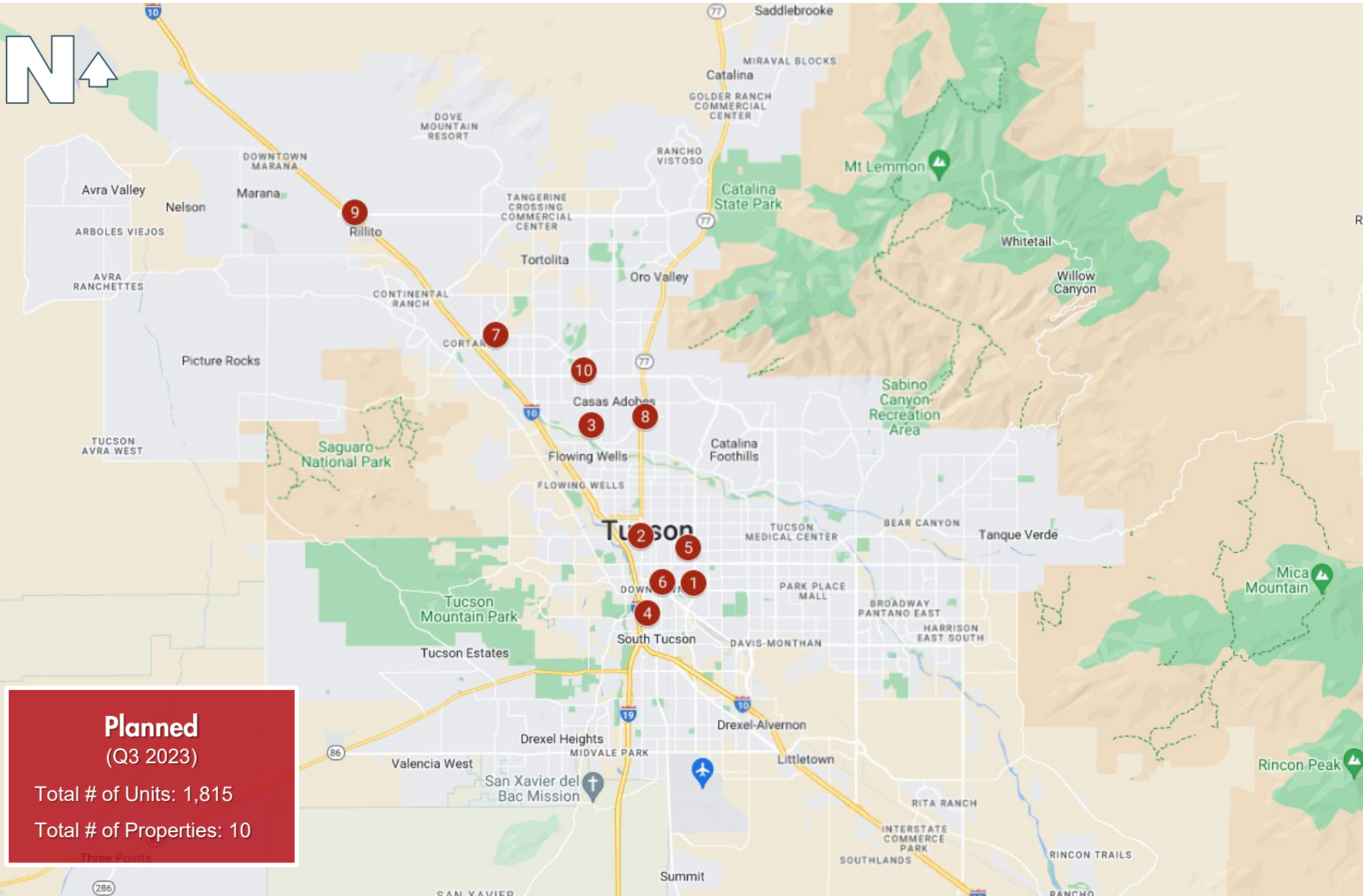

**Planned**  
(Q3 2023)  
Total # of Units: 1,815  
Total # of Properties: 10

**PLANNED (50+ UNIT PROPERTIES)**

	<b>Property Name</b>	<b>Address</b>	<b>Units</b>	<b>City</b>	<b>Developer</b>
1	Trinity, The	400 East University Blvd	58	Tucson	R + R Develop
2	Milagro on Oracle	2425 North Oracle Rd	63	Tucson	City of Tucson
3	Aerie Northwest	2050 West Oracle Jaynes Station Rd	144	Tucson	Aerie Development
4	Presidio Palms Phase II	475 North Granada Ave	154	Tucson	Sterling Real Estate Partners
5	Hub V, The	1001 North Park Ave	161	Tucson	Core Spaces
6	Corbett Building	340 North 6th Ave	192	Tucson	Stiteler, Scott
7	Cortaro 57	West Cortaro Farms Rd & North Sandy Desert Trail	200	Marana	Cardenas Cevallos, Juan Carlos
8	Quail Canyon Golf Course	North Oracle Rd & West Rudasill Rd	210	Casas Adobes	Urbaneer Investment Partners
9	Arise Mandarinina	North Mandarinina Blvd & West Tangerine Rd	283	Marana	Family Development
10	Uptown	7395 North La Cholla Blvd	350	Tucson	Bourn Companies
<b>Total Planned</b>			<b>1,815</b>		

**TOTAL UNIT INVENTORY**  
 10+ UNIT PROPERTIES: **101,839**  
 100+ UNIT PROPERTIES: **72,083**

**PRE-LEASE ABSORPTION RATE**  
**11**  
 Units/Property/Month  
 (Q3 2023 Avg)

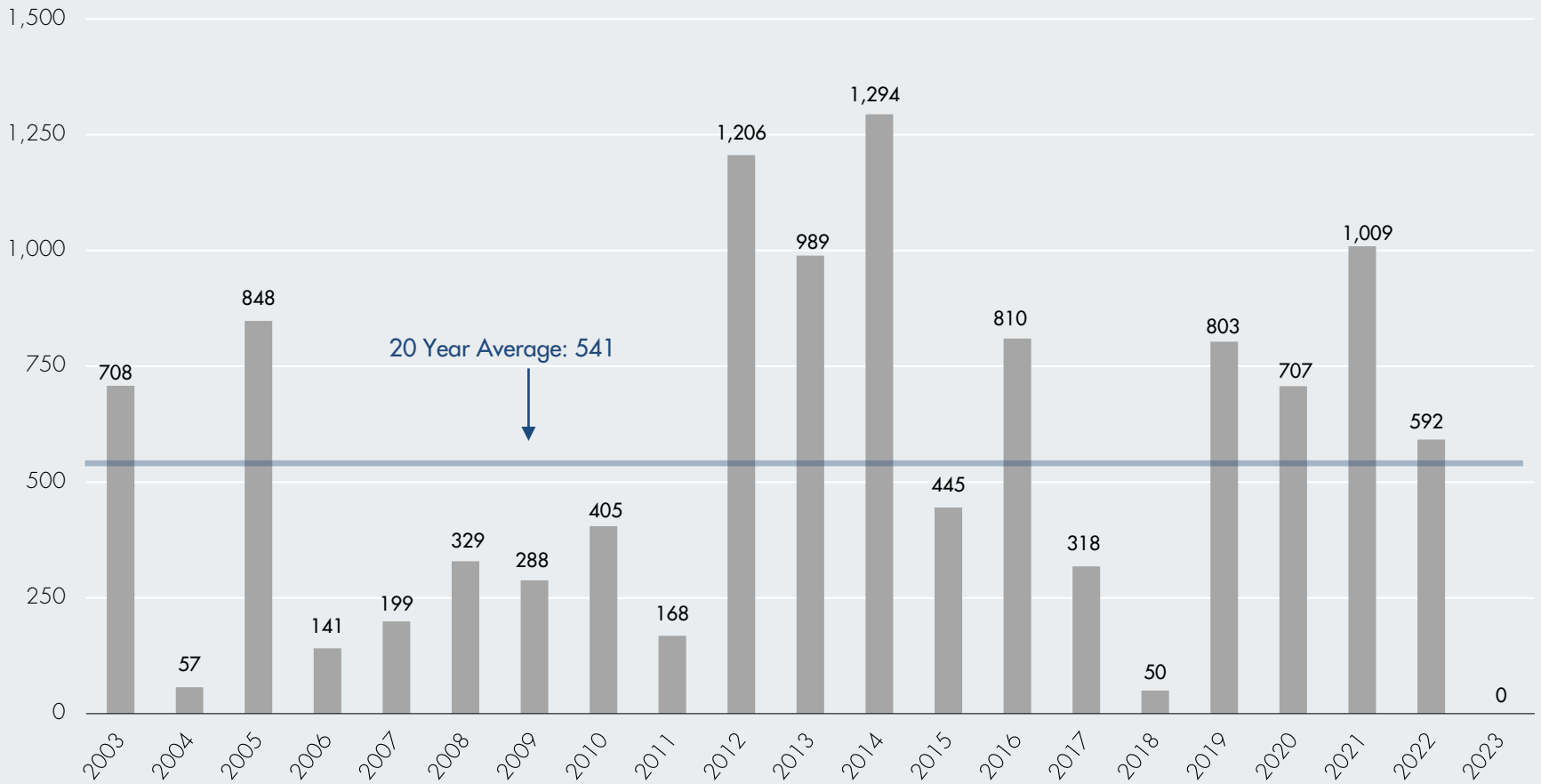



# Leading Multifamily Brokerage Team in the Western US

200+ YEARS OF COMBINED MULTIFAMILY BROKERAGE EXPERIENCE

SEASONED ADVISORS WITH REGIONAL INSIGHT

COLLABORATION & COOPERATION

## Apartment Brokerage & Advisory Firm

ABI Multifamily is a brokerage and advisory services firm that focuses exclusively on apartment investment transactions. The experienced advisors at ABI Multifamily have completed billions of dollars in sales and thousands of individual multifamily transactions.

### TUCSON OFFICE

#### RYAN KIPPES

VICE PRESIDENT

**520.265.1895**

ryan.kippes@abimultifamily.com

AZ Lic #SA660419000

#### DESIREE PALMER

VICE PRESIDENT

**520.265.1993**

desiree.palmer@abimultifamily.com

AZ Lic #SA682872000

#### NATHANIEL MCADOO

ASSOCIATE

**520.265.1945**

nathaniel.mcadoo@abimultifamily.com

AZ Lic #SA698399000

### PHOENIX HQ

5227 N. 7th Street  
Phoenix, AZ 85014

602.714.1400

### LAS VEGAS OFFICE

9830 W. Tropicana Ave., Ste. 180,  
Las Vegas, NV 89147

702.820.5660

### SAN DIEGO OFFICE

1223 Cleveland Avenue, Ste. 200  
San Diego, CA 92103

858.256.5454

### TUCSON OFFICE

3360 N. Country Club Road  
Tucson, AZ 85716

520.265.1993

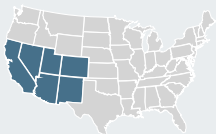
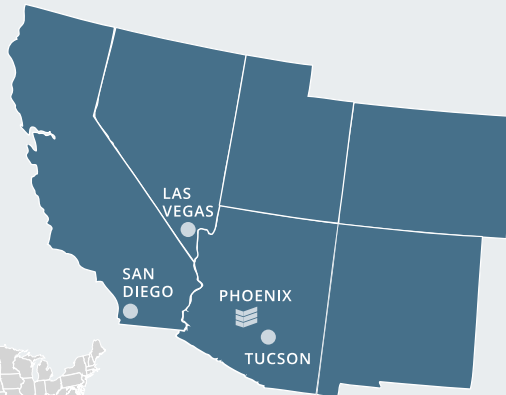

DISCLAIMER © 2023 ABI Multifamily | The information and details contained herein have been obtained from third-party sources believed to be reliable; however, ABI Multifamily has not independently verified its accuracy. ABI Multifamily makes no representations, guarantees, or express or implied warranties of any kind regarding the accuracy or completeness of the information and details provided herein, including but not limited to the implied warranty of suitability and fitness for a particular purpose. Interested parties should perform their own due diligence regarding the accuracy of the information. SOURCES: ABI Research / Bureau of Labor Statistics / Census Bureau / YARDI Matrix / Vizzda / US Chamber of Commerce / RED Comps / ARMLS / CoStar Group / RealPage